

# Cable Tray Supports

## CABLE TRAY SUPPORTS

MUST BE USED IN PAIRS

### 9132R

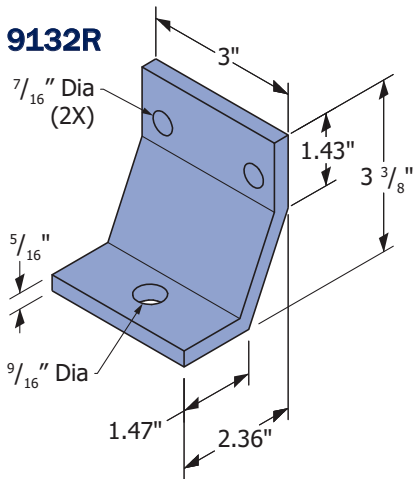

### 9132S

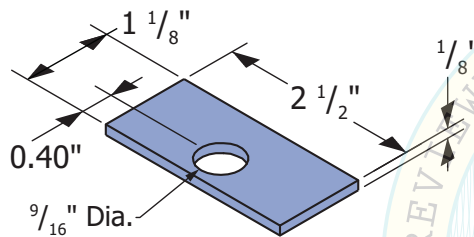

**Material / Finish Specifications**  
9132R, 9132S

**Material:** ASTM A36 Steel  
**Finish:** ASTM A153 (HDGAF)

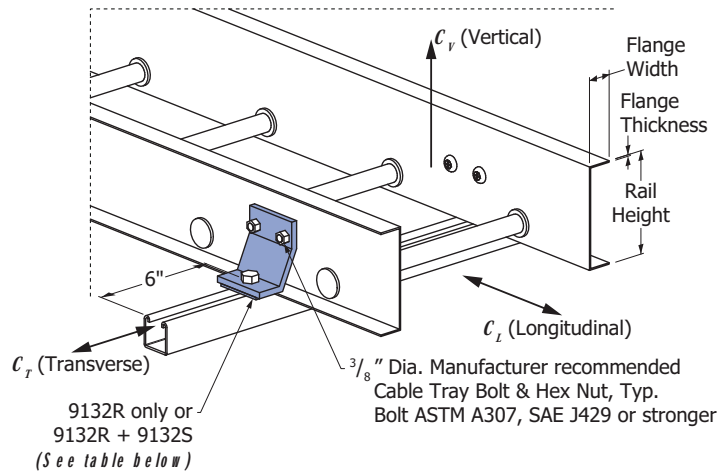

### Design Loads (lbs) (Total Per Pair)

$C_V$ Vertical	$C_T$ Transverse	$C_L$ Longitudinal
1,210	1,370	1,210

**Notes:** 1) Clamps must be used in pairs, as shown

### DETAIL 5E.1-1: CABLE TRAY ATTACHMENT TO STRUT

OPM-0295-13  
Steel Cable Tray  
Rails ASTM A653 Gr 33, ASTM 1008 Gr 33  
ASTM A1011 Gr 33 or stronger  
12 ga. Min. Thickness  
BY: Jeffrey Y. Kikumoto  
DATE: 03/02/2020  
(2) 3/8" Dia. Manufacturer recommended  
Cable Tray Bolt & Hex Nut, Typ.  
Bolt ASTM A307, SAE J429 or stronger  
Connection per Page 5a.1

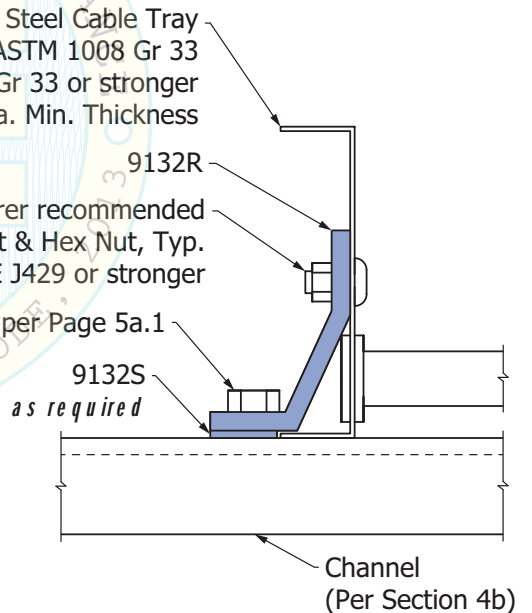

Flange	Rail Height	Flange Width	Flange Thickness	Use
Flange Facing Inward	3 1/2" or Greater	Any	Any	9132R Only
Flange Facing Outward	3 5/8" or Greater	1 1/4" Max.	1/8" Max.	9132R + 9132S

**Notes:**

- 1) Designer shall confirm cable tray attachment values which may govern.
- 2) Cable Tray shall be approved on a project specific basis, or preapproved by OSHPD. Spacing limits set by the manufacturer shall not be exceeded. Cable Tray brace spacing shall be approved or preapproved by OSHPD.



16100 S. Lathrop Ave  
Harvey, IL 60426  
Toll-Free: (800) 882-5543

www.unistrutseismic.com

*Rami Elhassan*  
Structural Engineer: Rami Elhassan  
California SE No. 3930

Page:  
**5e.1**